

SITE CHARACTER AREAS

- APPLICATION SITE BOUNDARY
- BOUNDARY - LAND IN OWNERSHIP OF THE APPLICANT -
- CHARACTER AREA 001
- CHARACTER AREA 002
- CHARACTER AREA 003

ORDNANCE SURVEY IRELAND LICENCE No. AR 0029319
© GOVERNMENT OF IRELAND

Clip Extent / Area of Interest (AOI):
 =====
 LLX,LLY= 711982.4417,774169.9151
 LRX,LRY= 712597.4417,774169.9151
 ULX,ULY= 711982.4417,774999.9151
 URX,URY= 712597.4417,774999.9151

Reference Index:
 =====
 Map Series | Map Sheets
 1:5,000 | 2320
 1:2,500 | 2320-C

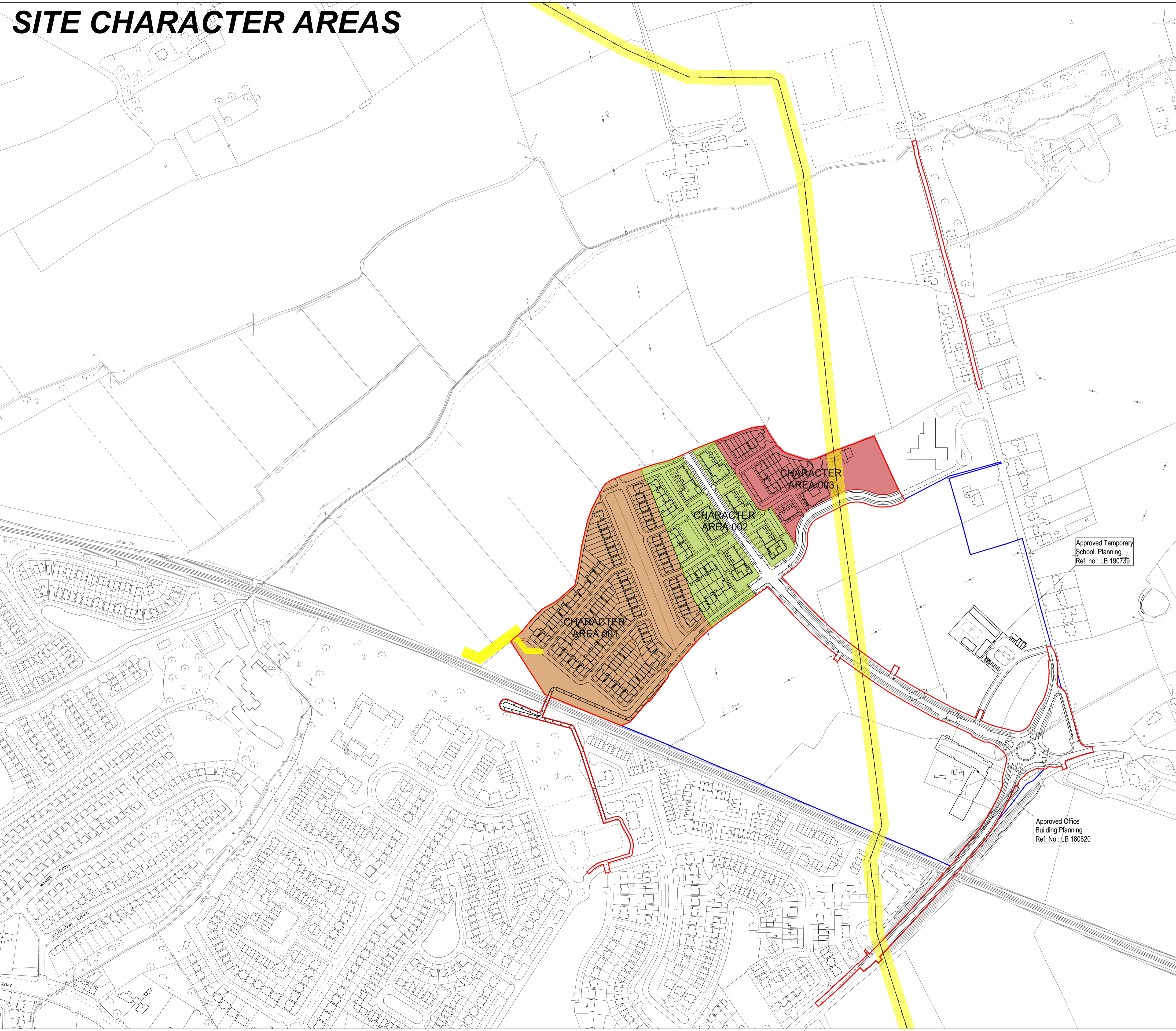

NOTE:
 Do not scale from this drawing, written dimensions only to be used. This drawing is for planning purposes only & not for construction.
 Levels shown are for information purposes only & may not relate to O.S. Malin Head Datum.
 For actual O.S. Malin Head Datum always refer to the Site Layout Plan.
 DDA Architects Ltd. retain copyright and ownership of this design which is not transferable.

REV	DATE	BY	CHKD	DRWN

DDA **DUIGNAN | DOOLEY**
ARCHITECTS AND PLANNING CONSULTANTS

62 BRIGHTON SQUARE, DUBLIN 6

TEL : 00 353 (1) 490 0499
EMAIL : info@ddaarch.ie
WEB : www.ddaarch.ie

RIA

THIS DRAWING IS COPYRIGHT © FIGURED DIMENSIONS ONLY TO BE USED		PLANNING	CAD:
CLIENT : SHANNON HOMES DROGHEDA LTD	PROJECT TITLE : COLP WEST SHD DROGHEDA	DRAWING NUMBER : 19-001-P-1.014	REV: PD
DRAWING TITLE : SITE LAYOUT PLAN CHARACTER AREA	DATE : OCT 2019	SCALE : 1:2500@A1 1:5000@A3	DRAWN : MA
DRAWN : MA	CHKD : PD	DATE : OCT 2019	SCALE : 1:2500@A1 1:5000@A3